



mission control board

MCB

Mission 3845
Guard Bashir A
OTW to Al Jafilya Station
25.2333328,55.2896943



MCB Mission Control Board

Track and Dispatch Staff

The Mission Control Board works with the MCB Android app to locate and provide interaction between your base station and your mobile staff.

Know where your employees are, who is available, geofence them, send them missions, dispatch them on surveillance tours or visit and delivery itineraries.

Get proof of presence to your customers plus documented reports with pictures and videos to enhance your services.

Missions, Jobs, Checkpoints, Itineraries, Visits, Deliveries, Pick ups, Tours, etc...

MCB makes sure you know which of your employees are available and dispatch them where you need the job done, no matter how you call them.

You can prepare itineraries for scheduled work with both **MCB plug-in for SECURITHOR** or the stand alone **MCB Go!** It's not limited to Guards and Patrolmen. Use itineraries for Delivery men, alarm system installers, maintenance staff, repairmen, visiting nurses, school bus pickup etc.. Organize routes for them and get checkpoint arrival confirmations, reports, picture or video proof.

Multiple features give you control on your mobile staff such as vehicle pairing and Geofencing of both authorized and forbidden zones.

Confirm your staff presence with automatic reports to your customers including both geolocation and confirmation of NFC or QR code scans.

Report of Samedi by Sheldon Cooper

Started: 1:39 AM Ended: 2:48 AM Status: Completed

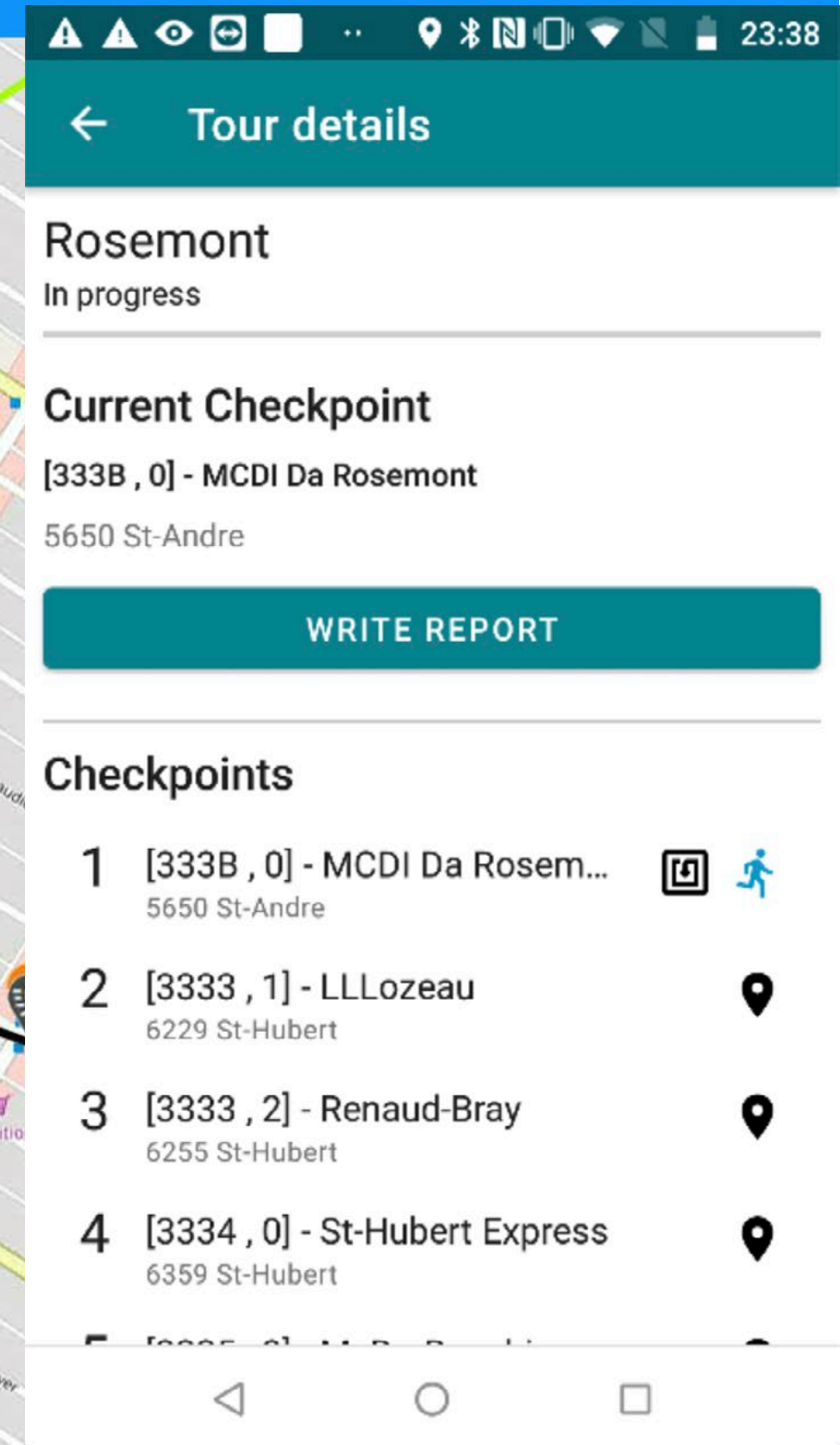

The MCB app

MCB is the multi tool your mobile staff needs. It does much more than a guard wand! It's the vital link between your base station and mobile staff.

MCB app is not just a tracker for your staff. It's a way to communicate missions, itineraries, and get your staff reports with videos and pictures.

Connect up to 200 staff members to MCB by using the free Android app.



Staff uses the MCB app to scan NFC tags or QR codes for double confirmation of presence at visited site.

Languages

MCB app is available in English, Arabic, Español, Français, German, Greek, Hindi, Indonesian, Malaysia (Bahasa), Nepalese, Português, Romanian, Swedish, Ukrainian, Turkish. Contact MCDI to add languages.

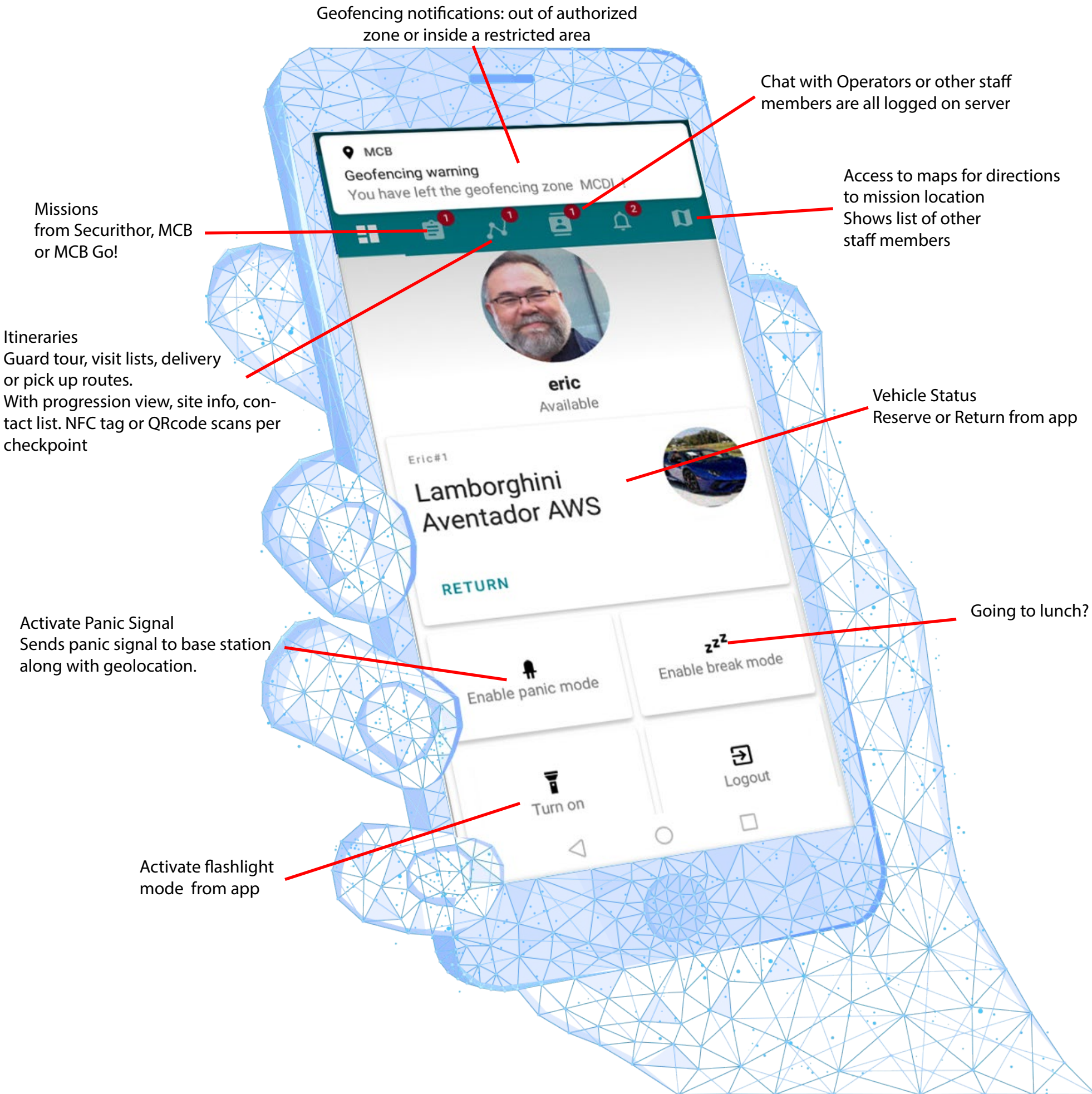

Not only for Guards and Patrols!

You don't need Patrolmen and Guards to use MCB.

MCB for SECURITHOR and **MCB Go!** will work for all your Mobile Staff no matter if they are doing pickup routes, school bus runs, delivering medication, equipment servicing, customer visits, building management, cleaning offices or security interventions.

Simply track your employees with the MCB app or their Android phone. View where they are on the map and send them jobs, either on demand or on schedule.



MCB Go! is designed to manage your mobile staff if you do not need to transfer jobs from the SECURITHOR Monitoring Software. It works completely stand alone without the SECURITHOR Monitoring Software.

Minus the alarm event transfer, MCB Go! has the same functionalities as the SECURITHOR Plug-in: track employees, send them missions or itineraries on demand or schedule.

All the geofencing, QR code/NFC tags scanning, vehicle pairing, Reports with pictures/videos from staff are present in MCB Go!

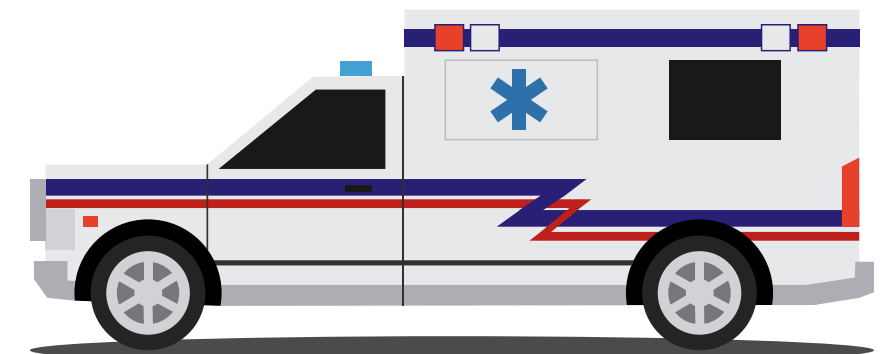
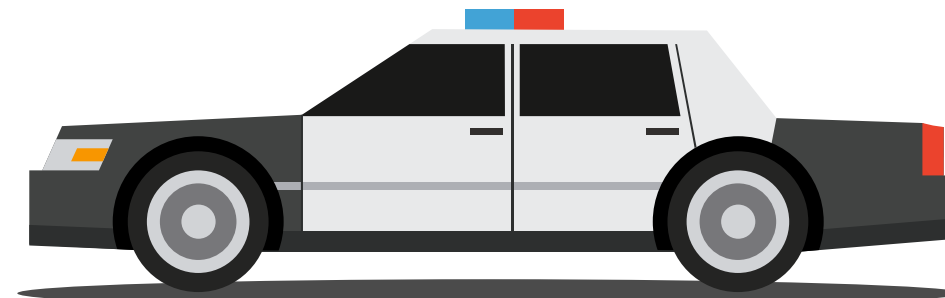
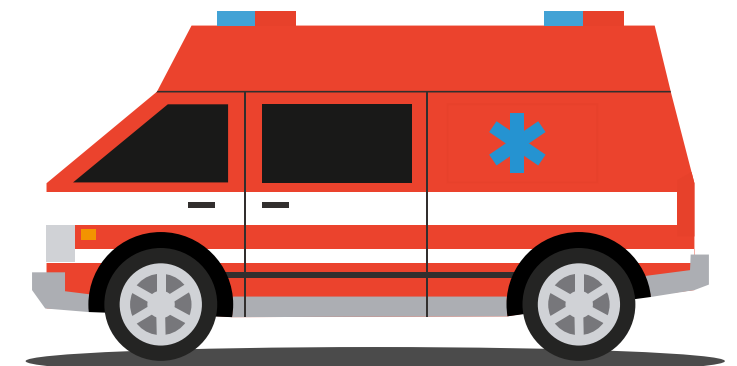
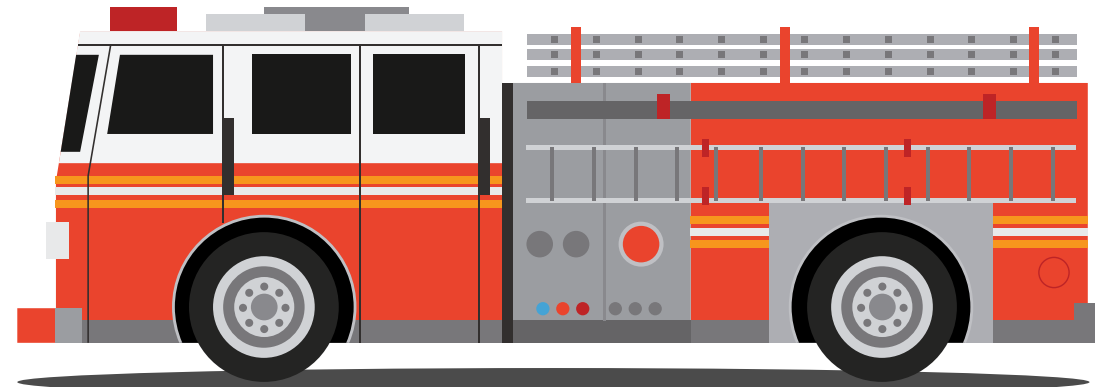

Where's W ?

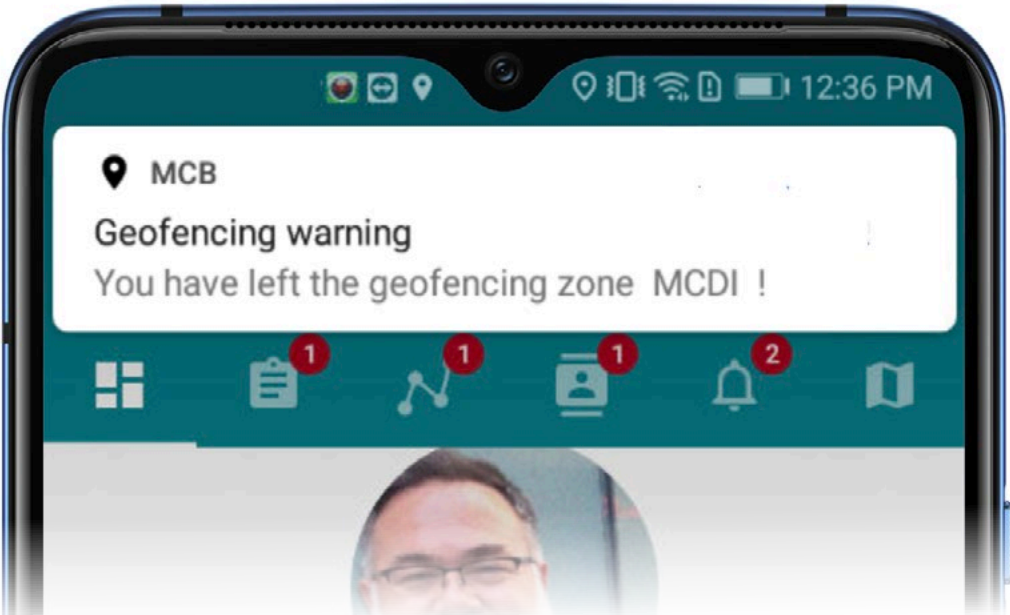

geofencing notifications appears when entering a forbidden zone or when leaving an authorized one.

GEOFENCING: IN OR OUT

Draw zones on a map to assign staff members to a location. You will know if employees arrive on time and if they stay at their posting. Both base station and staff know because they get a notification when they step out of the authorized zone.

Select forbidden zones to prevent unauthorized visits or to enforce allocated territories. Both type of geofencing are easily set on a map with drawing tools.

Forbidden zones show clearly in red

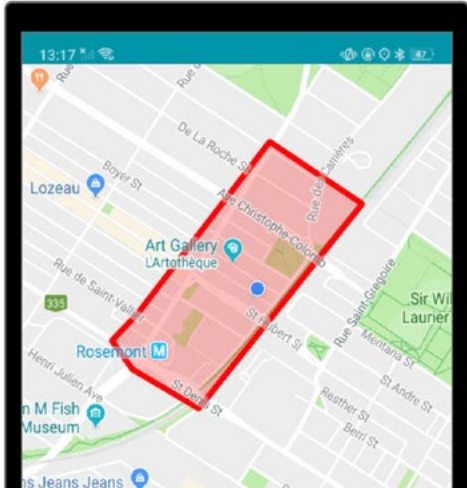

Authorized zone in MCB app shows in green

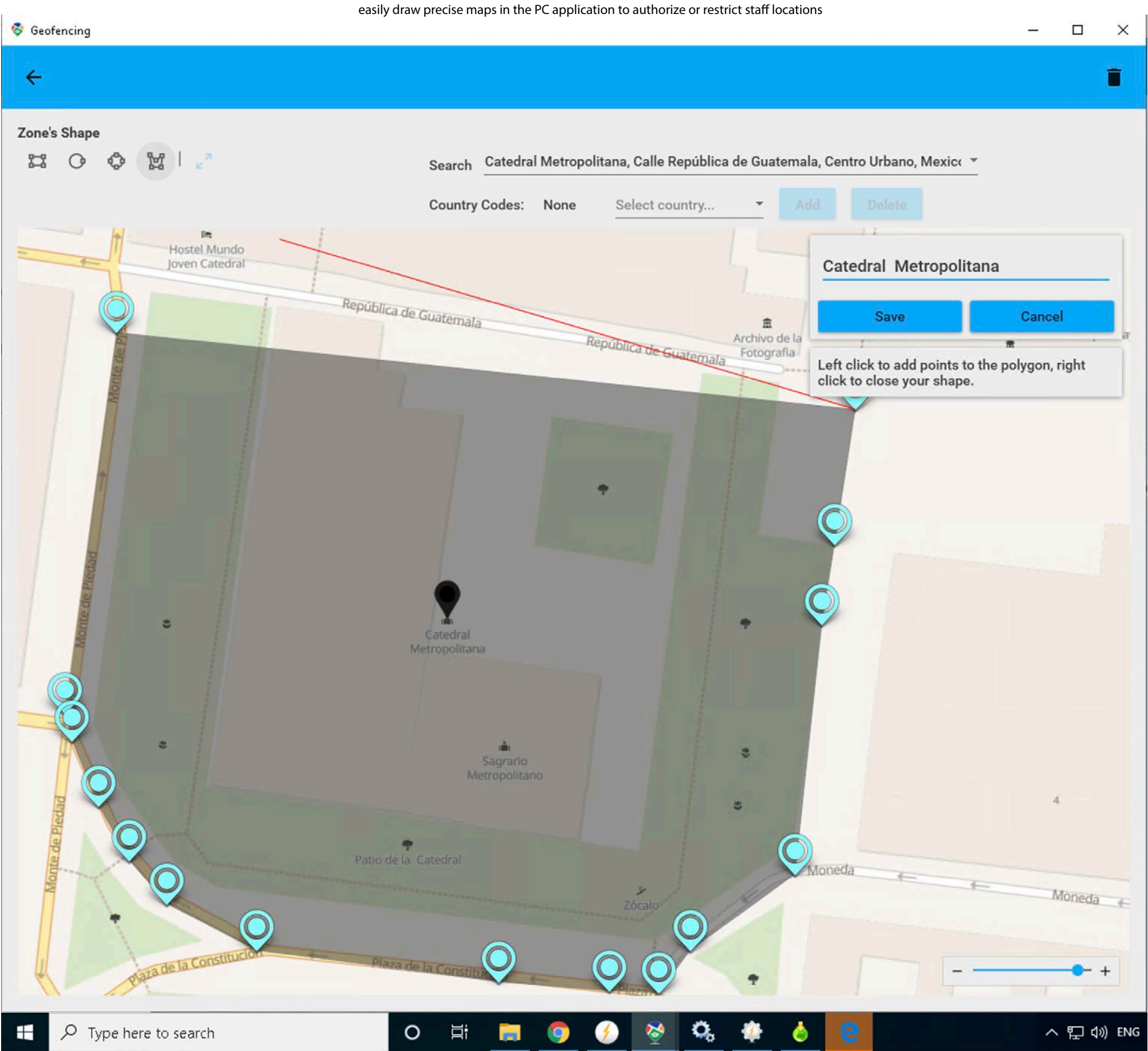
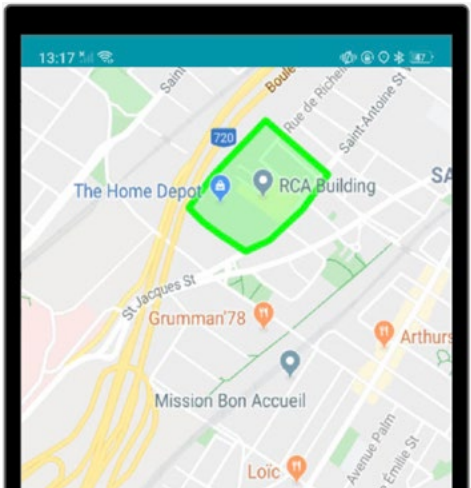

I'm here!

Prove your service prestation to your customers by automatically sending visit reports by email or sms. Reports includes geolocation data, staff report with on site pictures and videos.

Double your proof with QR codes or NFC tags scans at checkpoints and delivery or pickup sites. They are included in the email/sms report that is sent to the customer or supervisor.

Need to know

- who was where at midnight?
- where did your staff go today?
- who was the nearet to your customer at 13h00?

You can find this information in MCB and offer a proof of presence to your customers.

Confirm presence with MCB

Each staff member is tracked along his journey. No matter if it's on the way to a Checkpoint or when scanning a tag. You can query their route to a location or get their location at a specific time. Place NFC tags to confirm your staff presence at checkpoints or on equipment to service.

Email or SMS visit reports

MCB will send an email each time a checkpoint is completed. Use this feature to send a quick report to supervisors or customers. Email confirms location, report written by your staff, which NFC or QR code was scanned along with a link to view picture or videos taken by staff at the checkpoint location. Best way to prove your services!

Select as many addressee as you like. Reports are sent by email or SMS

Reports are sent seconds after completion of the checkpoints or cumulative at end of itinerary

Identification of the Checkpoint.
Green checkmark confirms the visit is sucessful

Time of completion with report entered by your employee

Icon shows tag type (NFC or QR) with it's own designation.

Report for tour #33

Checkpoint with position #1

✔ [333B - 0] MCDI Da Rosemont - MCDI Da Rosemont

Completed at **Thursday, December 19, 2019 10:43 AM (Eastern Time)** by **yoda : all is ok, the back door was locked. Nobody inside.**

More information

📄 Id: 04E07F62625780

Attachments

📎 9.jpg

Completed successfully.

Clickable link. Opens location in Google Maps

Pictures or video taken by visiting staff are uploaded for online viewing by customer.

DOUBLE VERIFICATION

Add NFC tags or QR Codes

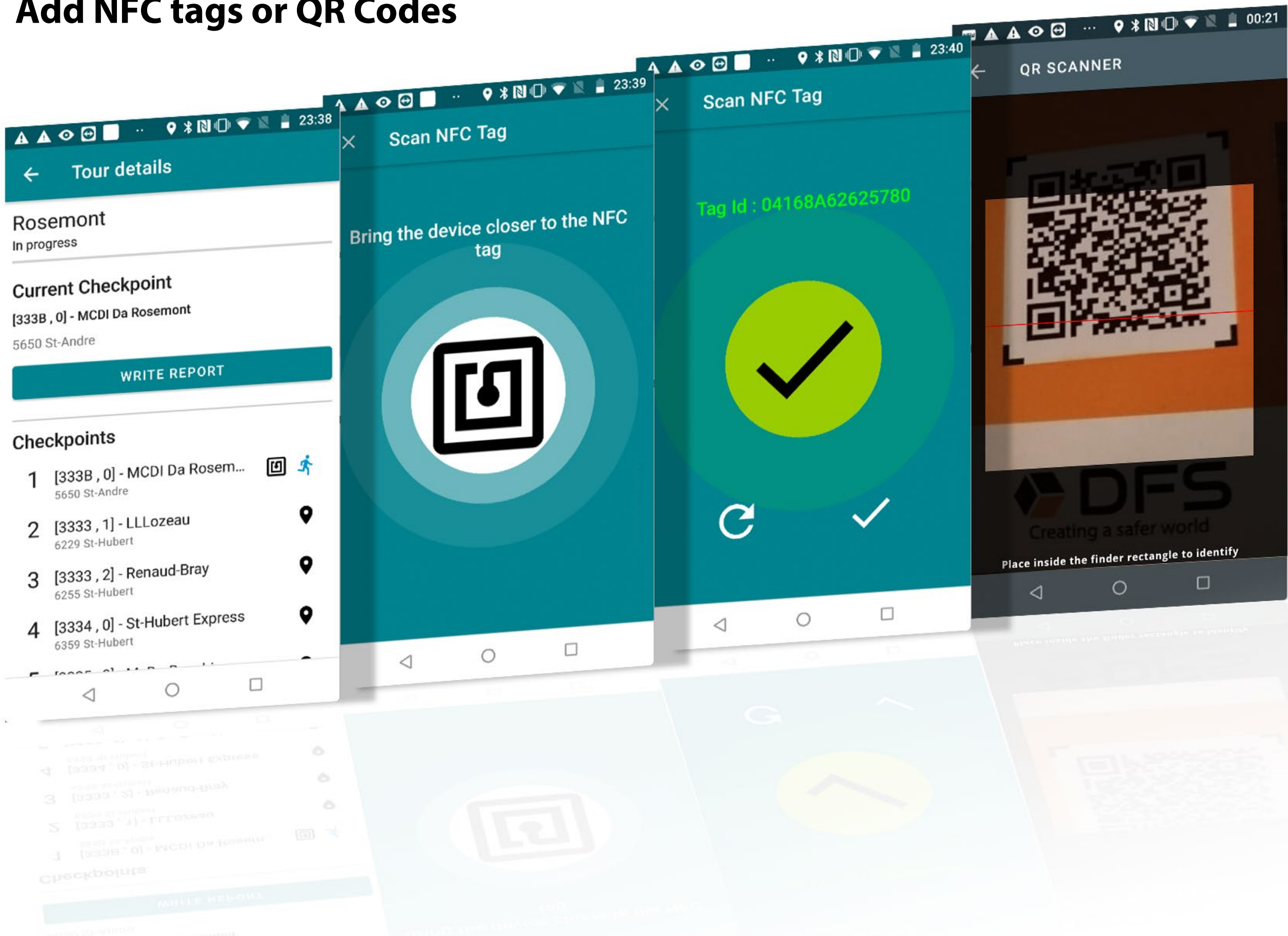

Place NFC tags or QR codes to confirm your staff presence at checkpoints or on equipment to service.

Using their phone and MCB app, staff members are required to scan NFC or QR. This makes a double verification added to the geolocation recorded.

Scanning a tag insures that employee goes to all floors or visits every room required in a tour. It also forces staff to go to the end of a room or verify a back room.

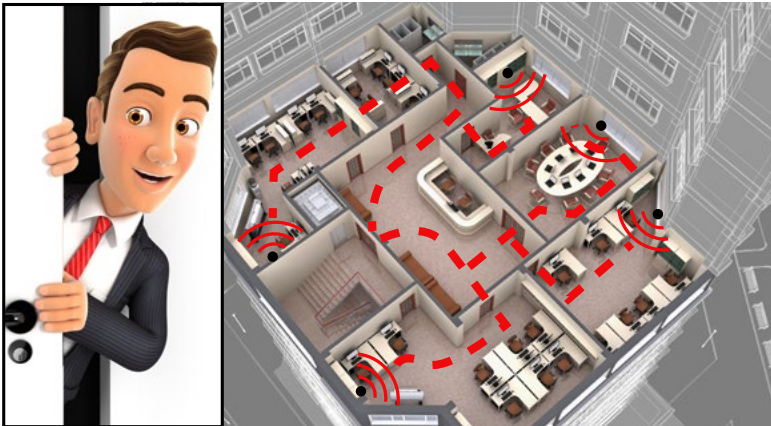

Scanning a tag affixed to equipment confirms the machine been worked on, a delivery site, a pick up site.

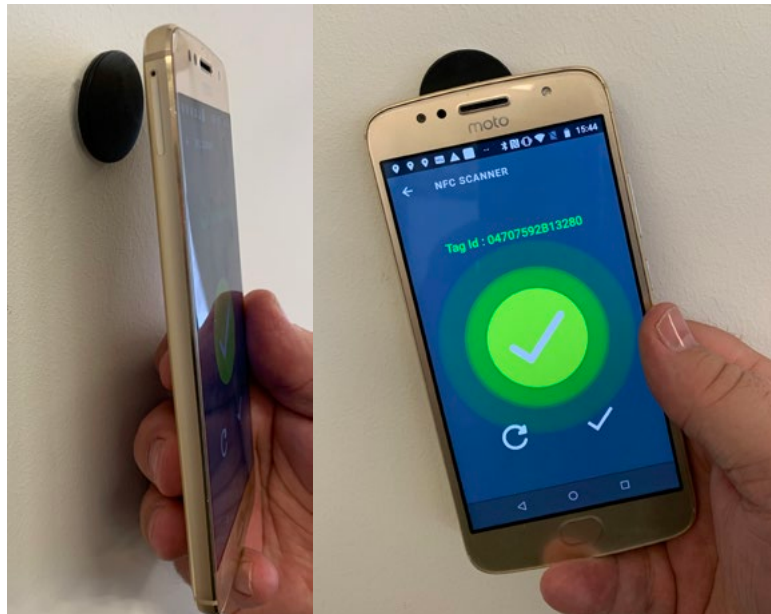

SPECIFICATIONS

DT42/DT42m

Alarm receivers

DT42	receiver, alarms over IP
DT42m	receiver, alarms over IP and phone lines

Power supply: 100-240V AC input 50-60Hz, output 5Vdc 2.4A
Consumption:
DT42/DT42gb: typical less than 1.1A 5VDC
DT42m/DT42gbm: typical less than 1.2A 5VDC

Communication:
DT42gb: ethernet, usb, serial
DT42m/gbm: ethernet, usb, serial, analog phone

Dimensions:
5.720" L x 5.750" W x 1.635"H (excluding connectors and rubber feet)
Rack-mount width 19 inches, height: 1U, 6.5 in deep
Finish: bright orange enamel, black serigraphy.

Android app: 5.1+ with notifications enabled. Access to Google Notifi-cations

Formats and brands supported

Ajax Hub (2019+ models))
AMC Elettronica
ARTEC AR88
Bosch 6512
Cirrus 4T
Climax TW
Digiflex Bosch
Dinsafer
ENIP
Elides/Elides Kronos
Focus/MEIAN STIII FC-7688plus
GSD Global Security Devices
Hikvision AXIOM
INIM SmarLiving and Prime
Kerui/Wolfgard G9B0
King Pigeon G5
Knookbox
Ksenia
Scientech LS-30
Trikdís G09/G16/SP231GC17
Mars-Commerce Zeus
NETIO
M2M Services Bulgaria- America
MLR2
Nookbox
Nanocomm (nanomir)
NAV87XX
Novation Security
Optex Genio ST/ Genio Advance
PIMA Force Series
Pyrnix ENIP
Rightkey
Risco Lightsys 1 SIA
Risco Agility
Roel Multicomm, CERBER, Xguard IP
ROF
SATEL gprs-a
SECOLINK Pas816, GSV5, GSV6U
Scientech TW
Sigma GR
SUPA L16
Tecnoalarm
Telesignal
Telenot
Trikdís G09/G10/G16/G17/ SP231
TOPKODAS GTalarm2, GTM1
TELL
Vanderbilt Flex C (special license)
SIA DC-09 2007 TCP/UDP
SIA DC-09 2011 TCP/UDP
SIA DC-09 2012 draft TCP/UDP

SIA DC-09 2013 TCP/UDP

SIA DC -09 2017 TCP/UDP

On request, without tech support: 3i NX1/NX2, Paradox IPDOX, VdS (Abus implementation)
Verify connection details with MCDI as they can vary by model within the same brand.
On request, without tech support:: 3i NX1/NX2, Paradox IPDOX, VdS (Abus implementation)
Verify connection details with MCDI as they can vary by model within the same brand.
Verify connection details with MCDI as they can vary by model within the same brand.
Ports opening and forward to DT42 according to alarm formats and usage. Number of sites supported varies according to re-
porting frequency and encryption level.

Memory 12,000,000 events stored in DT42. Equipped with a removable
micros SD card for logging. Logs can be downloaded to PC over ethernet.

Languages Configuration interface in French, English and Spanish.

Warranty period

DT42 is backed by MCDI SP 2 years limited warranty. Programming up-
dates are free during the warranty period.

DT42 is reporting in standardized formats to most Automation Software
on the market including SECURITHOR V2, SECURITHOR V1, WinSAMM,
SAMM, A-traq, Bold Gemini, Bold Manitou, Centralworks, MAS, Mi-
crokey, Patriot, SIS, SIMS. Direct IP connection to third party software
available with supplied component.

DT42 specifications are for version 2 and for units shipped as of May
2019

MCB Mission Control Board

As a plug-in for Securithor or stand alone module MCB Go!

MCB Mission Control Board

Workforce Track and Dispatch.

Configurations:

MCB as a plug-in for Securithor: 10,25,50,100 users

MCB Go! Stand alone application: 25,50,100 users

Technical requirements

MCB Android app 7+ . 80MB space. GPS capacity and Internet connec-
tion for communication to station.
Bandwidth according to size of information transferred.

Station requirements (PCB application, staff of 10, no other application
sharing PC with PCB to the exception of SECURITHOR FOR MCB plug-in):
Minimum for trial: i3, 4GB ram, 10GB HDD for installation.
Hostname or static IP. One port dedicated and forwarded to PCB PC
Bandwidth according to size of information transferred.

Contact MCDI for production requirements as they vary according to
usage and number of connected staff.
Compatible outgoing mail server and ftp space for checkpoint notifi-
cations.

NFC tag use requires compatible phone with NFC reader and compatible
NFC tags.
QR code scan requires compatible phone with camera and Android QR
code resources.

MCB app uses phone's gps-a system for geolocation and geofencing.
Must be enabled at all time.

Internet connectivity and link to MCB Server must be insured at all time
for optimal use. Some feature might not work without internet con-
nectivity.

Phone's camera use requires accepting relevant permissions.
Some feature may not apply to all phones or tablets.

SECURITHOR MONITORING SOFTWARE

Configurations

Single PC:

STL Starter kit

ST1 SECURITHOR V2 one station, unlimited accounts

NETWORK EDITION:

STS Server license

STWx Workstation license according to number selected.

SECURITHOR Add-on Modules (options)

APS Assistance app for iPhone and Android.

Compatible with Android 5+ and iOS 10+

Individual phones not supported.

Bluetooth button offered as recreational or convenience purposes.



Range and connection according to Bluetooth environmental capacity
at site of use and characteristics of phone and battery capacity.
Geocoding and Mapping in Rendez-Vous system requires maintaining a
Securithor support plan.

CAM/CAM Premium

STL: option

ST1: CAM included, CAM Premium as option

STS: CAM included, CAM Premium as option

CAM module

SDK Integration:

Hikvision, Dahua, EPCOM

CAM Listener for direct Hikvision and Dahua device alarms.

Automatic opening of provisioned video feed with pre-alarm

Video feed recording.

Audit trail for activation without prior alarm signal.

Screenshot on demand for MCDI Viewer.

Control of zoom, iris, focus, ptz, 2 way audio, relays (when applicable)

External jump http link, rtp, rtsp, jump to external windows app

Pre-alarm per device for SDK integrations.

CAM Premium

All in CAM module plus the following:

.Reference images tool in selected MCDI Viewers.

.SDK Integration: Cubitech Tribrid, Dahua, Elmo, Focus H&S, Hikvision,

IDIS, TVT, Vivotek.

.CAM Listener: alarms from selected Dahua and Hikvision Cameras and
DVR.

For SDK integrations:

Video feed recording

Pre-alarm opening (setting per device)

Screenshot capture on demand.

.External jump http link, rtp, rtsp, jump to external windows app
.Interface communication: Bosch CBS, DAVANTIS Daview, Frontel (Vid-
eofied), Visonic Visnap (with MCDI VOD) and Visonic Power Manage.

As courtesy, without technical support:

.Bridge to P2P Hikvision**, ONVIF**

Update of third part cameras, devices DVRs via Securithor update.

Contact MCDI to get the camera matrix list

.App personalization

.Dedicated support plans.

SECURITHOR Minimum Requirements

To operate trial:

Intel process i3, 4GB Memory, 40GB space on disk

To operate for production:

Contact MCDI as minimum requirement vary according to usage and
traffic.

OS: Securithor user interface can operate under Genuine Windows 7, 8,
10, .net framework 4.6.2. required.

Servers license: compatible with Genuine Windows 7, 8,10, 2012, 2016
Pro version recommended with latest update. .net framework 4.6.2 re-
quired.

Email and SMS

SMS notification works with third part compatible modem not supplied
with Securithor: Sony Ericsson GM28/29 GT47/48, Janus, Telit 864
family, Siemens/Cinterion mc52i, mc65. Number of modem and gateway
capacity must be sufficient to handle traffic generated by Securihtor.

Email notification requires a third part compatible outgoing mail server
not supplied with Securithor. TLS 1.1 and 1.2 required. Server capacity
per second/minute/hour/day must be sufficient for traffic generated. No
write/read receipt management.

MVP MAP VIEWS AND PLANS

Plug-in Module for SECURITHOR

Minimum requirements:

For display of maps: recent quad i7 with fast video card.

8GB Memory dedicated to video

Access to video camera equal to Securithor license.

MVP is not intended to process large volume of alarm signals. Securithor
should be preferred for this task. Map views require maintaining a Se-
curithor support plan.

Push Notification Service by MCDI

Connects SECURITHOR to Push Notification system by Apple, Google.

Yearly service by MCDI. Hosting in Canada.

Requires stable and continuous internet connection to MCDI server.

Bandwidth according to traffic.

Alarm Station app available for Android and iOS (iPhone and iPad).

Provisioning via STnet provides individual subscribers registrations.

EXPRECIUM D phone line receiver

Communications (Ed and D4)

2 RJ11 type jacks for connection of phone line

Type: Pulse, DTMF, FSK

Reception Speed: 10, 20, 40 pps DR / CS

Handshake and Kiss-off: 1400Hz /2300Hz/2225Hz

Pulse Frequency: 1800Hz / 1900Hz

Telim//Robofon: 1180Hz / /1100Hz

Reception Formats supported (Ed and D4):

Acron	Radionics 6500
Ademco:	Radionics extended
- Slow/Fast;	Sescoa Slow, Super Fast
- Contact ID;	Sescoa Standard
- Extended;	SIA
- Express;	Silent Knight Slow
- High Speed	Stratel
FBI Super Fast	Napco Point ID
3x1	BFSK,CFSK, VFSK)
4x1	3x1 extended
4x1 extended	3x1 extended compressed 4x2
4x2	4x1 extended compressed 4x2
MC42	Zero removed 3x1, 4x1, extended.
Optex's Varitech	C&K: Bell 103A2
All boards are delivered with Bell 103 on both lines.	

Reporting protocols to Automation Software

Output as MCDI, SG MLR2 or Ademco 685. Some formats are not available to
all reporting protocols.

Printer Output:

Exprecium D supports Epson T Family POS printer through Serial com-
munication. Designed for Epson T88V USB and Epson LX 300 families.
Converters not supported.

Power Requirements:

From computer +12V Supply: 225 mA typ.

From 12V Battery (standby): 225 mA typ.

Station Requirements:

PC chassis with 12V electrical supply though PCI or PCI-E bus with full
length PCI or external 12Vdc power supply
Signal: USB 1.1/2.0/3.0 or Serial port.

Configuration tool : PC running OS allowing installation of .NET 3.5 such
as Windows XP, 2003, Vista, Server 2008r2, 2012, Windows 7, 8. 8.1
and 10.

DECRYPTA 4 phone line receiver

Power Requirements:

Auto reboot upon power restore. From 9- 12V DC Battery/ Power Supply:
250mA with fall-over management. Included power supply: 96-240V
auto-ranging. IEC13 power cord to wall outlet.
Energy saving automatically switches LCD backlight when switching to
battery.

Relay

D4 is fitted with an internal relay to trigger externally powered devices
such as a visual indicator, strobe light or siren. Terminal posts, dry con-
tacts, on D4 back for normally open and normally close positions. Relays
triggered each time an alarm signal is received by D4. Relay maximum
current 30VDC 1A max.

Station Requirements

D4 can be configured and operated without PC by menus on front display
in English, French, German, Italian, Portuguese, Russian and Spanish.

Configuration by PC through USB or serial port. PC configuration tools
requires installation of Microsoft .NET 3.5 framework supplied on D4 CD.
PC configuration tool in Arabic, English, Farsi, French, Italian, Portuguese,
Russian and Spanish. POS printer of compatible with Epson T family .
Designed to use with Epson T88V.

Relay Relay triggered each time an alarm signal is received by D4, Relay
maximum current 30VDC 1A max. NO or NC available.

Caller ID service must be provided by Telco (Bellcore type 1 or compati-
ble ETSI types) for Calling phone number to display.

Reporting protocols to Automation Software

Output as MCDI, SG MLR2 or Ademco 685. Some formats are not

available to all reporting protocols.

DRIVERS AND COMMUNICATION

USB drivers supplied 7, 8, 8.1, 10, Server 2012. Serial communication
with DOS, Linux, and Windows. D4 can be configured and operated
without PC or with PC using OS with .net 3.5 enabled.

Warranty period: 2 years limited warranty for Ed and D4.

MCDI SP 2 years limited warranty. Programming updates are free during
the warranty period. Power surges from phone lines are specifically
excluded. Wired pstn phone line required on both signal sending and
receiving ends. Requires signal integrity at receiving end. Individual
signal quality troubleshooting not performed nor provided by MCDI.

Rohs compliant, FCC, IC, CE, TBR21, EN50136

All requirements are subject to change without further notice. Some requirements should be
adjusted according to usage. Minimum requirements may be higher if usage differs from stan-
dard operations. Consult MCDI to validate operational requirements. All requirements are stated
for stand alone operation or MCDI products without sharing resources with other applications
or equipment.

All software products with assumption a genuine Windows OS is used, maintained and updated.
All software products require admin user and a standard Windows without modification of reg-
istry, configuration and security level.

MADE IN CANADA

ARGENTINA, URUGUAY

FIESA S.R.L.
Av. De Los Incas 4154/56
(C1427DNT) Capital Federal
Buenos Aires Argentina
Tel (54 11) 4551-5100
ventas@fiesa.com.ar

AZERBAIJAN

A+A Security LLC
24-B, Akhmed Bey Aga oqlu st.,
Baku, AZ-1008, Republic of Azerbaijan
Tel.: +99412 480 54 84 (ext. 417)
ali.g@aplusa-security.com
http://www.aasecurity.az

BOLIVIA

DSS Digital Security Systems
Calle Joaquín de Velasco #444 Esq.
Puerto Suarez Paralela Calle
Charcas entre 1ero y 2do anillo
Tel: +591 3 335 3800
dss.com.bo

CANADA

Caribbean and West Indies
Caribes et antilles françaises
Guyane Française, Haïti, Martinique,
Guadeloupe



MCDI Security Products inc.
Montréal HQ
English, Français: +514-481-1067
Línea directa en español: +514-487-0441
securithor@mcdi.com
mcdi.com securithor.com

CENTRAL AMERICA

Belize, Cuba, Dominicana, Guatemala, Guyana,
Honduras, Nicaragua, Panama, Surinam, Ven-
ezuela

EPCOM International Sales Dept.
En Español
Oficinas en El Paso, Miami, San Diego,
Chihuahua
p. +(305)889 1127, +(915)533 5119
w. www.epcom.net , www.syscom.mx
s. montana@epcom.net

MCDI De México

En Español: +514-487-0441
México: +52 618 825 4493
ventas@mcdi.com

CHILE

Videovision
Fonos (02) 2848 48 69
Direccion: Joaquin Walker Martinez 3520 –
Ñuñoa – Santiago – Chile
mauricio.rodriguez@videovision.cl
www.videovision.cl

COLOMBIA

SYSCOM Colombia
Cra 90A N° 64C38 Álamos Norte
SYSCOM Oficina: +57 (1)7443650
www.syscomcolombia.com
ventas@syscomcolombia.com

COSTA RICA

INTRADE ABC
Sabana Norte, Edif. ICE 200 Norte 100 E.
San José, Costa Rica
TEL: (506)290 4604
edgar@intradeabc.com

DACH Deutschland, Österreich, Schweiz

SIREUS GROUP GmbH

Am Wickenstück 15
61462 Königstein i.Ts.
Germany
Fon +49 6174 / 99393-0
info@sireusgroup.com
www.sireusgroup.com

EL SALVADOR

**SIT SISTEMAS DE INTEGRACION TECNO-
LOGICOS, DISTRIBUCION DE SISTEMAS DE
SEGURIDAD**
Av. Los bambues # 191-A, col. Miralvalle
Tel 503-284-9108
SAN SALVADOR, EL SALVADOR
sitecnicos@yahoo.com

GHANA, WEST AFRICA

IM Technologies
Ph: +233576547760, +233543514453
2nd darko lane north kaneshie point 4 Accra.
Accra, Ghana
info@imtechnologiesgh.com
Skype:isaac863

GUATEMALA

COSESA
1era. Avenida 4-23 Zona 9
Guatemala, Guatemala
(502) 2360-0880,
ventas@setelco.com.gt
www.cosesa.com.gt

INDIA

DFS Services Pvt Ltd
Unit 267-268
Bagmugaliya extension
Katara Hills
Bhopal 462043 INDIA
0755 492 6677
www.dfsservices.co.in
securithor@dfsservices.co.in

ITALIA

VOYAGER s.r.l.
via Rivani, 37/b
40138 Bologna
www.voyager-srl.it
f.bassi@voyager-srl.it

MEXICO



En la República Mexicana:
Teléfono: 01 614 415-2525
En Estados Unidos
Teléfono: +1 915 533-5119
Ave. 20 de Noviembre #805
Chihuahua, Chih. C.P.31000 Méx.
Internacionales: (52)+(614)+15-
25-25
www.syscom.com.mx
ventas@syscom.com.mx

Middle East

AKSA Global Ltd.
Hassan Ahmed
Hassanua@outlook.com
Mobile Number : +447796988043
Skype : Hassan.u.ahmed

PERU

DSS Digital Security Systems
Calle Joaquín de Velasco #444 Esq.
Puerto Suarez Paralela Calle
Charcas entre 1ero y 2do anillo
Tel: +591 3 335 3800
dss.com.bo

PORTUGAL, Angola, Brasil, Cabo Verde,
Moçambique

SANCO

Sérgio Lapa
sanco@sanco.pt
Rua dos Lagos, 545,
4405 - 875 Vila Nova de Gaia
+351 223 710 845

ROMANIA, MOLDOVA

Velsigur SRL
Bd.Republicii 50
Piatra Neamt
office@velsigur.ro
0040.744.123.047



SOUTH EAST ASIA
Australia, Cambodia,
Indonesia, Malaysia, New Zea-
land, Philippines,
Singapore, Thailand, Vietnam

STRATEL (M) Sdn BHD
12 Jalan Teknologi 3/3A,
Surian Industrial Park,
Kota Damansara PJU5
47810 Petaling Jaya, Malaysia
Tel: + 60 1 3341 5913
sales@stratel.com.my
www.stratel.com.my

Sudamérica

Todos los países

MCDI Do México

En Español: +514-487-0441
México: +52 618 825 4493
ventas@mcdi.com

MCDI Security Products Inc.
1001 Lenoir st. A411b
English speaking line: 1-514-481-1067
Spanish speaking line: 1-514-487-0441
mcdi@mcdi.com
www.mcdi.com

SWEDEN

Obecom
Öberg Communication AB
Romma Bengtsgattu 5
SE-793 91 Leksand
Sweden
+46-70 212 26 63
bert.oberg@obecom.se

UAE, BAHRAIN, OMAN, QATAR

MEDC
Middle East Distribution Centre L.L.C
Churchill Tower, Business Bay
P.O Box: 171745, Dubai U.A.E
Tel: +971 4 4278666
info@medc-dubai.com

UKRAINE

ITC HATISA
вулиця Уманська, 37,
Київ, Україна, 02000
bogdan@itchatisa.com
+380 (44) 390-63-07

U.S.A.

MCDI Security Products Inc.
1001 Lenoir st. A411b
English speaking line: 1-514-481-
1067
Spanish speaking line: 1-514-487-
0441
mcdi@mcdi.com
www.mcdi.com

MCDI SP products are also sold directly
in many countries where MCDI SP is not
represented. Contact us at:
sales@mcdi.com
+514-481-1067

BECOMING A MCDI DEALER:

We are currently looking for dealers in
several countries. If you think your orga-
nization can benefit from reselling MCDI
SP products, do not hesitate to contact
us with a brief presentation of your com-
pany, your local market and products
you already represent at:
dealership@mcdi.com
+514-481-1067

